



# GRAND BANKS

Dependable Diesel Cruisers

[www.grandyachts-spain.com](http://www.grandyachts-spain.com)®





The Grand Banks 50 is a complete ship. She is the ultimate in cruising comfort and luxury with a massive main saloon, three or an optional four private double staterooms with three complete toilet compartments. Along with this luxury of space is the exceptional finish of the Grand Banks 50. Golden Burmese teak highlights the boat both inside and out, with teak parquet soles, teak paneling, teak joinery-work and beautifully designed and executed teak furniture upholstered in modern decorator fabrics. The spacious saloon measures a full 11'7" x 20'3" with 6'6" headroom. The saloon features a long built-in "L" shaped settee with a teak table that adjusts in height to serve as a dining table or a cocktail table. There is also a writing desk, bookcase, lamp table, long buffet and fine freestanding furniture including a settee, chairs and stools for the elegant bar which separates the saloon from the galley. Large window areas add to the open feeling of the saloon and provide excellent visibility. The galley is conveniently

**GB  
50**

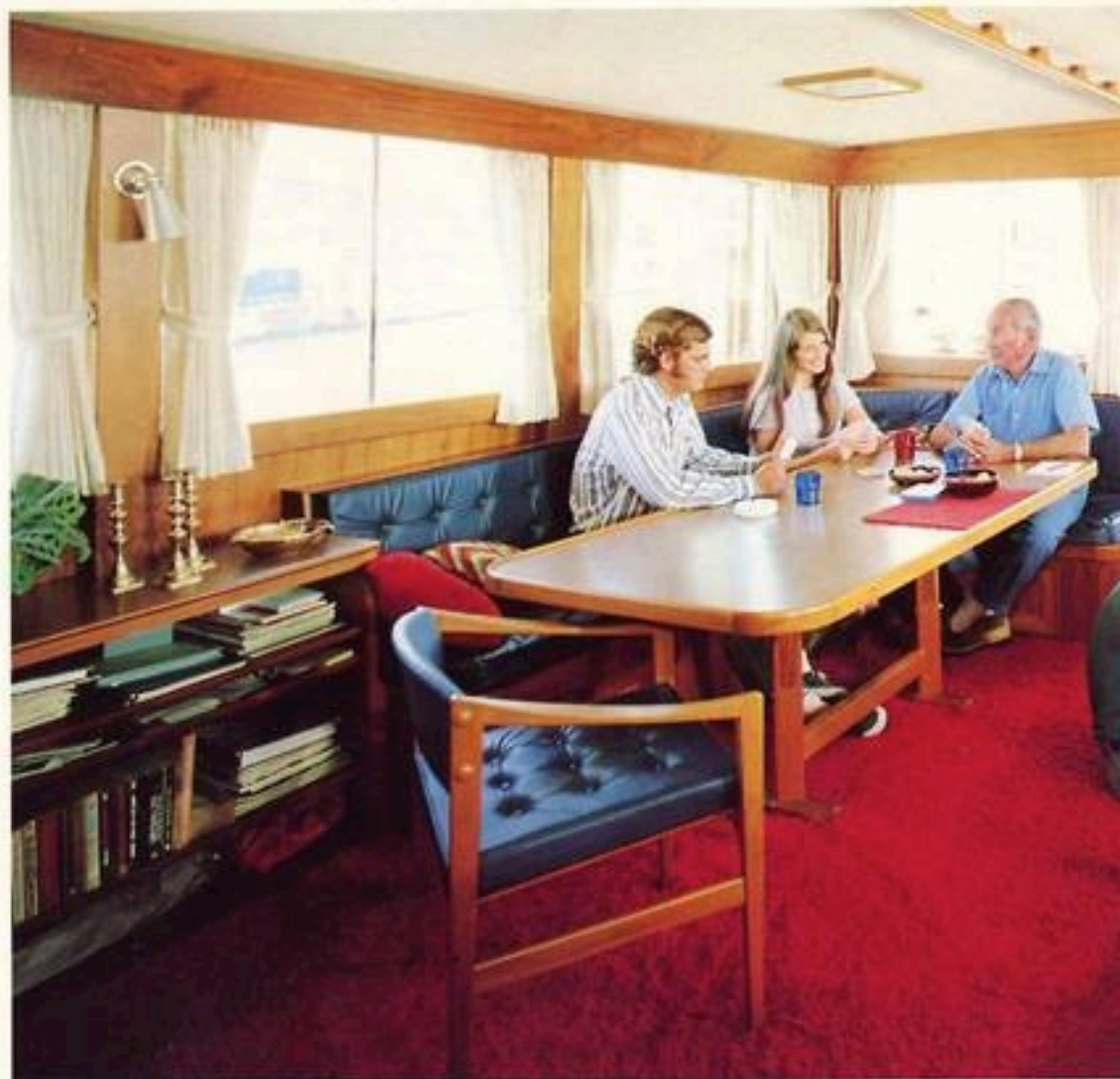





laid out and fully equipped with a four-burner gas or three-burner electric range with oven, double stainless steel basins, a double door refrigerator-freezer with ice maker and exceptional storage space under the expansive counter tops and in overhead cabinets. The separate wheelhouse is equipped with full instruments and controls, including a handcrafted teak wheel. There is exceptional space for mounting of navigational gear and there is a large settee built-in aft so the family can join in with the running of the boat. Teak doors to port

and starboard give ready access to the covered side decks. The master stateroom is a true owner's suite occupying an area more than 16' x 15' and includes a spacious private toilet compartment with marble counter, stainless steel basin and exceptional storage space. There is a roomy shower with full-size porcelain tub. The stateroom may be optionally equipped with twin or double beds and includes bureaus, a vanity and an exceptional amount of hanging locker space. In addition to the master stateroom, the Grand Banks 50 is offered with two





or three double guest staterooms. These staterooms are beautifully finished with teak parquet soles, teak paneling, teak joinerywork and fine teak furniture. Two private toilet compartments serve these guest cabins, each with lavatory counter, excellent storage space and showers. All of the machinery aboard the Grand Banks 50 is located in the two engine rooms. These full-headroom engine rooms are located directly off the main passageway and are fully sound-insulated. The engine rooms include plenty of space for servicing the main engines, generator and any additional equipment, and includes a built-in

workbench. From her 22" wide, walk-around side decks and uncluttered foredeck to her covered aft cockpit, the laid teak decks are protected with high bulwarks and sturdy teak rails. The fly bridge deck is surrounded with stainless steel rails and provides enough room for all the family and guests to sunbathe or sit comfortably on the built-in flying bridge furniture. The flying bridge is equipped with complete engine controls, instruments and steering. For cruising the oceans of the world; for living aboard in absolute comfort; for entertaining afloat or at dockside; or for seeking the quiet privacy of







out-of-the-way anchorages, it would be difficult to equal the facilities of the Grand Banks 50 in another vessel half again her size. She is the ultimate family cruiser offering long range diesel dependability in the luxury of handcrafted furnishings. The biggest little ship—the Grand Banks 50.

#### SPECIFICATIONS

LOA .....	50'11" (15.5 metres)
LWL .....	48'0" (14.6 metres)
Beam .....	16'0" (4.9 metres)
Draft .....	5'0" (1.5 metres)
Displacement .....	59,300 lbs. (26,898 kg.)
Water .....	500 gal. (U.S.) (1893 litres)
Fuel .....	1000 gal. (U.S.) (3785 litres)
Range .....	over 1500 miles (2414 kilometres)

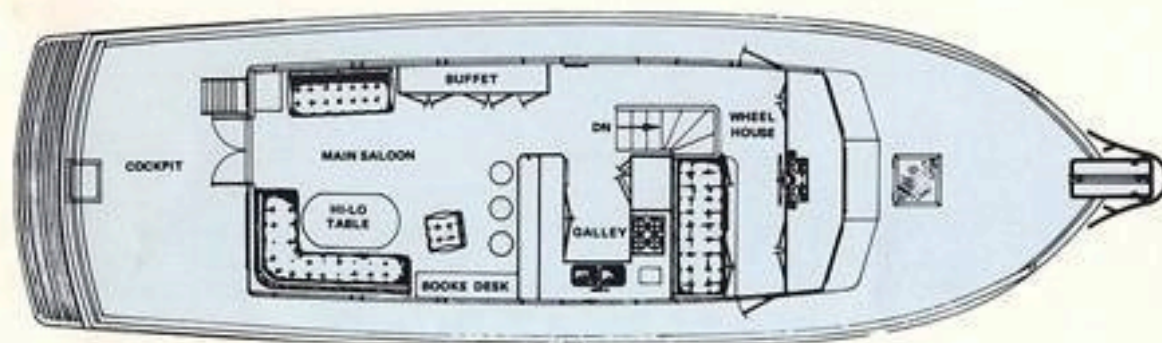
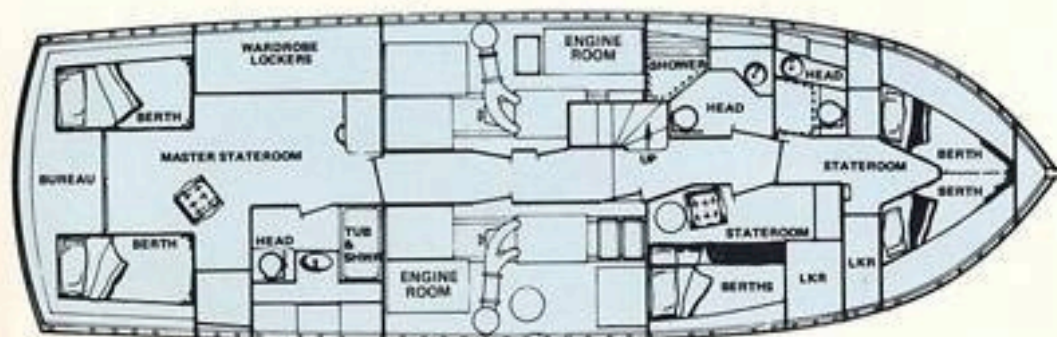

#### SAFETY FEATURES

There have been no compromises in the selection or design of the safety features included in the Grand Banks 50. These features include dependable mechanical steering with emergency steering capability, automatic alarms for engine oil pressure and water temperature, circuit breakers protecting all electric circuits, seacocks on all thru-hull fittings below the waterline, two watertight bulkheads and four bilge pumps. In addition, the wide walk-around side decks are fully protected by high bulwarks and solid teak handrails for safe, easy movement while underway. There are double stainless steel railings on the fly bridge and a bowsprit with stainless steel pulpit rails for safe and easy use and stowage of the anchor. Escape hatches are fitted for each below decks compartment and three-ply safety glass is used throughout. The engine room is ventilated by four electric blowers, the bilge is protected from engine oil by stainless steel drip pans, each fuel tank is fitted with a diaphragm-type shutoff valve and a master fuel shutoff valve is also provided.